

SBS-I-3-T

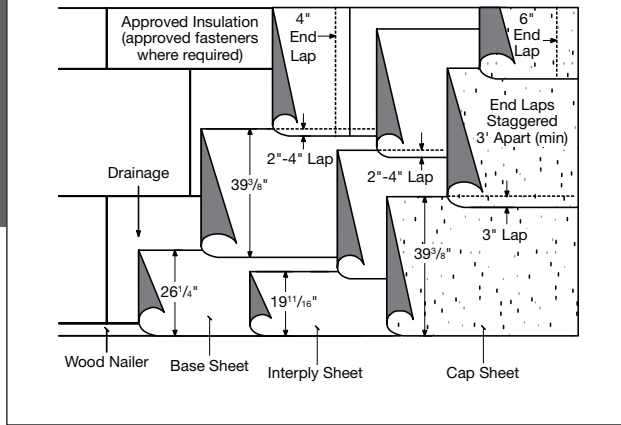

Insulated substrates: base sheet, one interply sheet, and an SBS modified cap sheet

SUBSTRATE:

- Steel (Sec. 3.5)
- Concrete (Sec. 3.6-3.9)
- Wood (Sec. 3.10-3.11)
- Poured Gypsum (Sec. 3.12)
- Insulation (Sec. 4.0)
- Re-cover (Sec. 5.0)

MAXIMUM SLOPE:

Up to 6" : 12" (Sec. 15.3)

ROOF ASSEMBLY:

One or more layers of approved insulation and/or coverboard:

- Base layer mechanically attached and additional layers mechanically attached or adhered in hot asphalt or approved adhesive.
- Base layer and additional layers adhered in hot asphalt or approved adhesive.
- Vapor retarder/anchor sheets (Sec. 4.7).

Approved base sheet set in hot asphalt (Sec. 7.0), torch-welded (Sec. 8.0) or self-adhered (Sec. 10.2).

Approved interply sheet set in hot asphalt (Sec. 7.0), torch-welded (Sec. 8.0) or self-adhered (Sec. 10.2).

Approved cap sheet, torch-welded (Sec. 8.0).

SUMMARY OF MATERIALS:

- One or more layers of insulation and coverboard
- Base sheet (1 ply)
- Interply sheet (1 ply)
- Cap sheet (1 ply)
- ASTM D 312 asphalt (two moppings) (No moppings if base and interply are torch-welded or self-adhered)

APPROVED BASE SHEETS:

(one of the following)

- All Weather/Empire® Base Sheet
- Black Diamond® Base Sheet (self-adhered)
- Flintglas® Ply 4
- Flintglas Ply 6
- Flintlastic Base 20
- Flintlastic Base 20 T**
- Flintlastic Ultra Glass SA (self-adhered)
- Flintlastic Ultra Poly SMS
- Glasbase™ Base Sheet

APPROVED INTERPLY SHEETS:

(one of the following)

- Black Diamond Base Sheet (self-adhered)
- Flintlastic Base 20 T
- Flintlastic Ultra Glass SA (self-adhered)
- Flintlastic Ultra Poly SMS
- Flintglas Ply 4
- Flintglas Ply 6

APPROVED CAP SHEETS:

(one of the following)

- Flintlastic FR Cap 30 T*
- Flintlastic GTS-FR*

FINAL SURFACING:

For optional surfacing see Section 14.0.

FLASHING ASSEMBLY:

- **Standard.** Over a base sheet or bonded to a primed substrate. One ply Flintlastic modified cap sheet, per CT detail.
- **Premium.** Over a base sheet or bonded to a primed substrate. One smooth and one granulated modified membrane flashing, per CT detail.
- **Premium Alternate.** Over a base sheet or bonded to a primed substrate. One smooth modified membrane and CT SmartFlash®, per CT detail.

Asphalt: Type III or Type IV (Sec. 7.0).

Cants: In angles of roof deck and vertical surfaces, the roofing contractor shall furnish and install an approved cant strip with a minimum 3" face.

*Available with CoolStar® reflective granules

**Over approved gypsum coverboards only

WARRANTY DURATIONS FOR THIS SPECIFICATION VARY BASED ON ROLL MATERIAL SELECTION; SEE WARRANTY MATRIX.

Applicable local building code may require more stringent installation requirements such as, but not limited to, increased fastener or adhesive densities to meet required wind uplift pressures. Consult local building code and uplift requirements prior to any application of CertainTeed roofing materials. CertainTeed is not responsible for failure to install roofing products per applicable local building codes.

Consult CertainTeed General Recommendations for noted section references.