

Anchor Sheet or Base Ply

Mechanically attach or fully adhere (self-adhered, torch, cold process or hot asphalt). Proper attachment of the base layer is defined by specified system, product selection and deck type.

Penetration Pocket

Shall have a 4" wide primed continuous flange and a minimum 4" height. Set in FlintBond® Trowel or hot asphalt.

Flashing Collar & Cap Sheet

Fully adhere (self-adhered, torch, cold process or hot asphalt), extending a minimum 4" beyond the metal flange. Proper attachment is defined by product selection. If self-adhered in cold weather¹ hot air weld² collar to metal surface.

Pan Fill

Fill the inside of the pan to within two inches (2") of the top with a non-shrinking grout. After the grout has set, fill the remainder of the pan with a one part pourable sealant.

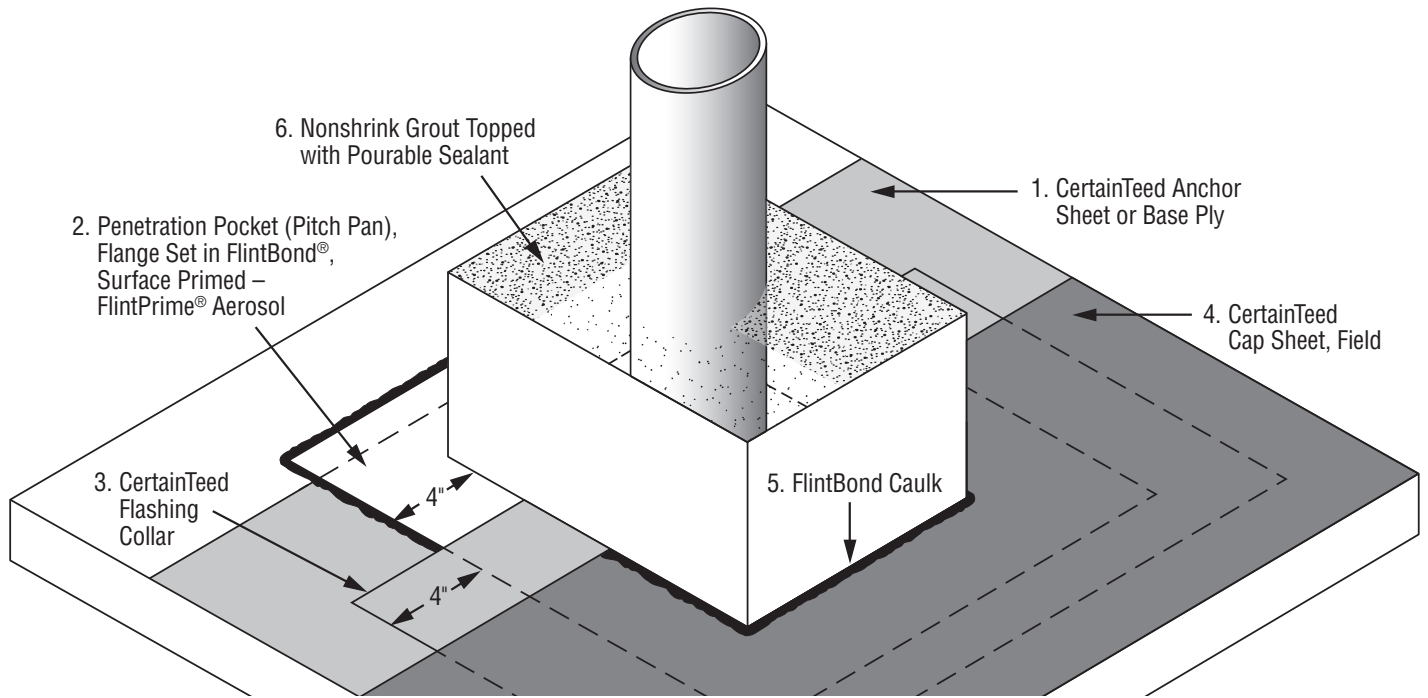

NOT DRAWN TO SCALE

Note:

Penetration Pockets are not the preferred flashing method at penetrations because they may be a maintenance problem. Please refer to SmartFlash Details for the preferred flashing method.

¹20°F-49°F (-6.6°C-4.4°C)

²Apply heat from a hot-air welder with a 2" tip to the metal surface while applying rolling pressure from a silicone roller to the overlapping Collar. With the hot air welder set between 300°F-500°F (setting 2-3), apply heat to the overlap interface while bonding Collar with rolling pressure onto the Metal. Roll the overlapping Collar in place, moving the hot air welder to allow for forward progress. Avoid applying so much heat or moving at a pace that results in smoke. Continue overlap application, 2" per pass.