

**Anchor Sheet or Base Ply**

Mechanically attach or fully adhere (self-adhered, torch, cold process or hot asphalt) Proper attachment is defined by specified system, product selection and deck type.

**Edge Metal**

Mechanically attach a minimum two staggered rows, 6" o.c. or as required by building code; endlaps should receive two nails. Edge Metal shall have a minimum 3/4" rise for gravel surfaced membranes and a 3/8" rise for smooth or mineral surfaced membranes.

**Cap Sheet**

Fully adhere in accordance with the approved, published product application method.

**Cap Sheet Flashing Strip**

Treat the granulated surface of Cap Sheet where granule overlap occurs: **If self-adhered or cold process** apply FlintBond® Trowel to entire lapped surface or (in cold weather<sup>1</sup>) hot air weld<sup>2</sup> with bead of FlintBond Caulk at edge; **If torch-welded** heat sink/scrape the granules with heated trowel or granular embedment tool and ensure 1/4" bleed out; **if using hot asphalt** ensure 1/4" bleed out.

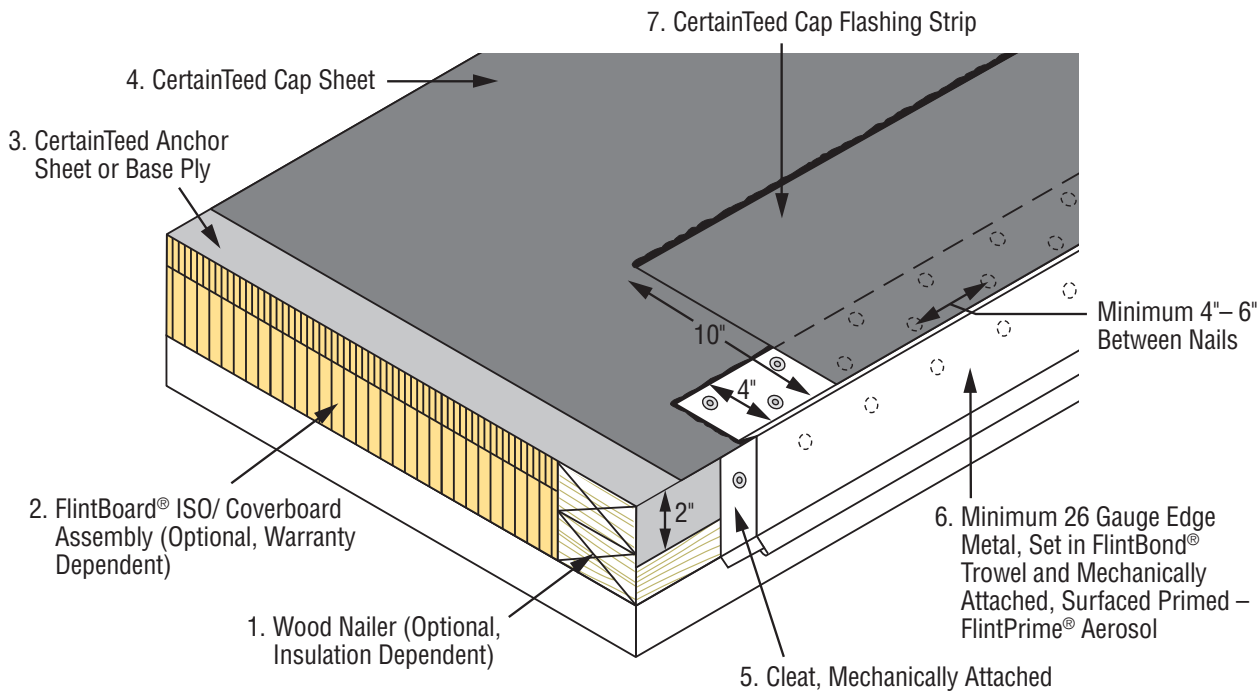

NOT DRAWN TO SCALE

<sup>1</sup>20°F-49°F (-6.6°C-4.4°C)

<sup>2</sup>Apply heat from a hot-air welder with a 2" tip to the overlapped granular surface while applying rolling pressure from a silicone roller to the overlapping Cap. With the hot air welder set between 900°F-1,100°F (setting 8-10), apply heat to the overlap interface while bonding Cap with rolling pressure on the granulated surface. Roll the overlapping Cap in place, moving the hot air welder to allow for forward progress. Avoid applying so much heat or moving at a pace that results in smoke. Apply a bead of FlintBond Caulk along the edge. Continue overlap application, 2" per pass.