

NOTE: This detail is intended for a liquid-applied roof restoration project. It assumes a preexisting roof membrane is being left in place in the field but divider flashing removed and sheet metal replaced.

Flintlastic/Bituminous Flashing Ply

For wood-based area dividers only, prior to applying SMARTCOAT, mechanically attach top and bottom edge of both sides of divider 9" o.c. with tin discs, see CertainTeed Commercial Roof Systems Specifications manual, General Recommendations, Section 15 for fastener details.

Reinforced Mastic (5-Course)

Apply SMARTCOAT 300 Series Mastic with a brush, trowel or gloved hand at a maximum thickness of 1/8" for 300 Acrylic Mastic and 1/4" for 350 Silicone Mastic. Immediately embed SMARTFAB 500 Polyester Reinforcement, minimum 6" width, into wet mastic followed by a second coat of mastic at prescribed thickness to encapsulate edges and surface of polyester. Ensure the polyester is evenly covered and the edges

of the detail are properly feathered. Once cured, repeat Mastic-Polyester-Mastic as prescribed above.

Liquid-Applied Membrane, Field/Divider

Once mastic is cured, apply coating in accordance with specified SMARTCOAT application. Extend coating up and over divider.

Multiple coats will be required to achieve specified mil thickness on vertical surfaces; it is not recommended to apply more than 1G per 100 sq. ft. in a single coat to avoid material sagging.

Allow SMARTCOAT to fully cure before installing Coping.

Mastic/Reinforced Mastic (3-Course)

Metal Joints/Fasteners

Seal all exposed metal fasteners with SMARTCOAT 300 Series Mastic or Sealant. Reinforce SMARTCOAT 300 Series Mastic with a brush, trowel or gloved hand at a maximum thickness of 1/8" for 300/301 Acrylic Mastic and 1/4" for 350 Silicone Mastic, with SMARTFAB 500 Reinforcement, at all corners and metal joints.

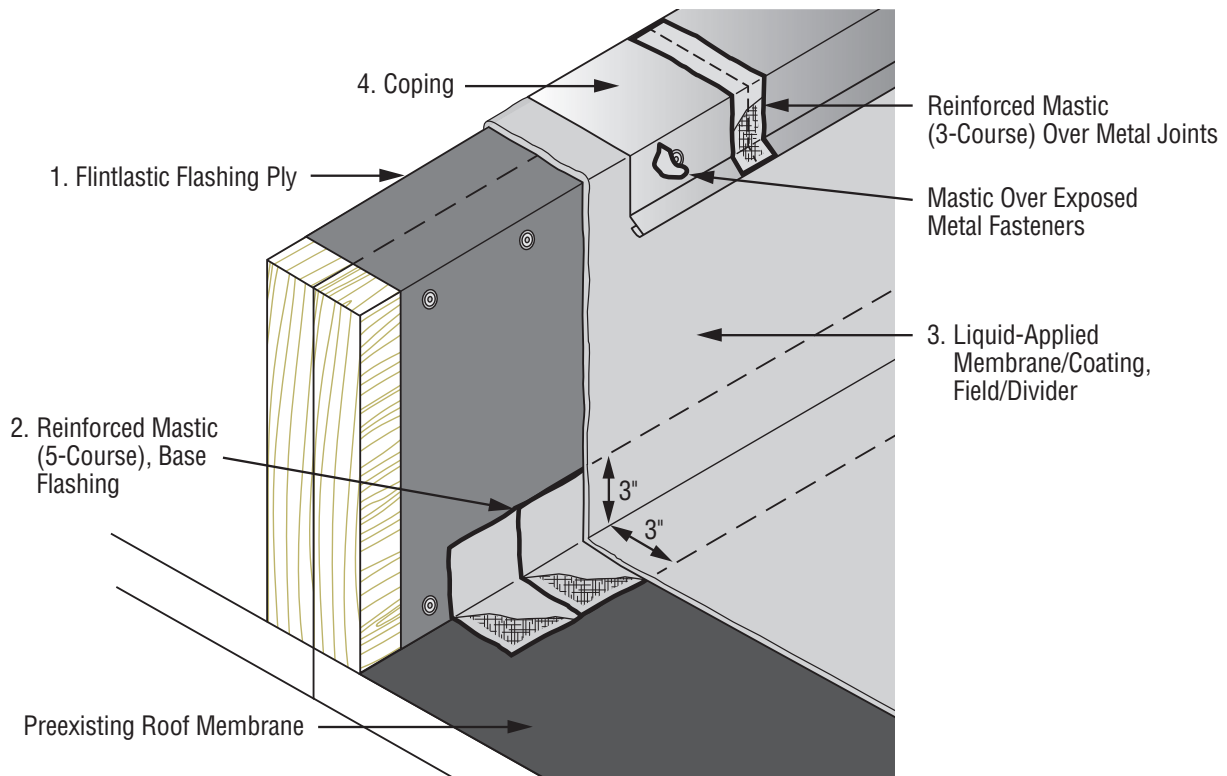

NOT DRAWN TO SCALE

NOTE: Never repair or coat-over silicone-based mastic or coating with anything other than a compatible silicone-based product; acrylic materials will not bond to silicone.

NOTE: When portions of the detail have undergone previous repairs and if the repairs have been made with compatible materials and are sound, repair can be left in place and reinforced mastic (3-course) applied atop; if the repair was made with incompatible materials, is failing or has potential for high movement, remove these materials and proceed with reinforced mastic (3-course/5-course as appropriate).