

Vapor retarders minimize the incursion of water vapor rising from the building interior into the roof membrane where it can accumulate and condense. The need for a vapor retarder should be evaluated by a design professional that has knowledge of the structure and local environment.

**CertainTeed's Black Diamond® Base Sheet**

This SBS-modified, self-adhered membrane, can be utilized as a vapor retarder and left exposed up to six months. Alternatively, the following CertainTeed membranes may be utilized as a vapor retarder:

- Flintglas® Ply 4 or Premium Ply 6 (two layers), applied in hot asphalt

- Any Flintlastic® base sheet (surface must be covered within 24 hours or primed prior to application of insulation or waterproofing/weathering roof membrane)
- Any Flintlastic cap sheet

The proper attachment of the vapor retarder is defined by product selection and substrate: **If self-adhered**, prime the deck or substrate with FlintPrime® SA; **if torch-welding** or setting **in hot asphalt**, prime the deck or substrate with FlintPrime. NOTE: Thermal Barriers such as FlintBoard® ISO HD must be installed over steel roof decks prior to the application of a vapor retarder.

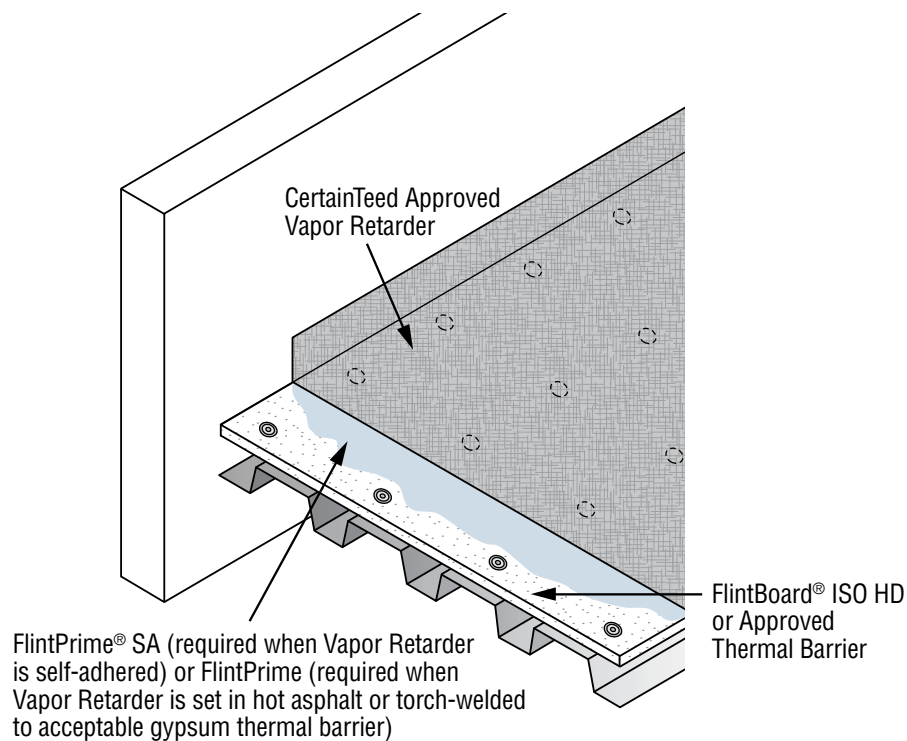

NOT DRAWN TO SCALE