

BUR(M)-I-4-A

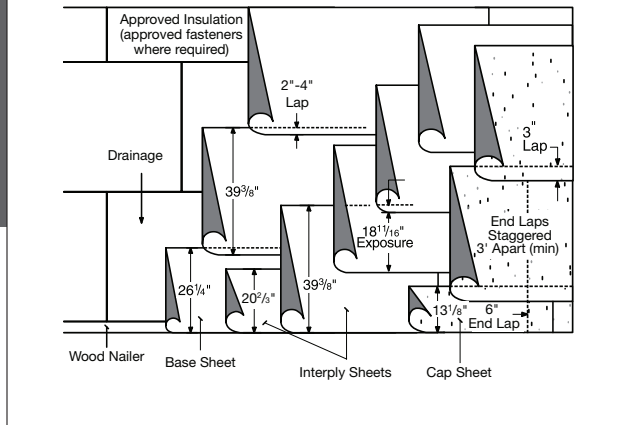

Insulated substrates: self-adhered SBS modified base sheet or hot asphalt mopped BUR or SBS modified base sheet, two hot asphalt applied BUR interply sheets and BUR cap sheet

SUBSTRATE:

- Steel (Sec. 3.5)
- Concrete (Sec. 3.6-3.9)
- Wood (Sec. 3.10-3.11)
- Poured Gypsum (Sec. 3.12)
- Insulation (Sec. 4.0)
- Re-cover (Sec. 5.0)

MAXIMUM SLOPE:

Up to 6" : 12" (Sec. 15.3)

ROOF ASSEMBLY:

One or more layers of approved insulation and/or coverboard:

- Base layer mechanically attached and additional layers mechanically attached or adhered in hot asphalt or Approved adhesive.
- Base layer and additional layers adhered in hot asphalt or approved adhesive.
- Vapor retarder / anchor sheets (Sec. 4.7)

Approved base sheet set in hot asphalt (Sec. 7.0) or self-adhered (Sec. 10.2).

Approved interply sheets set in hot asphalt (Sec. 7.0).

Approved mineral-surfaced cap sheet set in hot asphalt (Sec. 7.0).

SUMMARY OF MATERIALS:

- One or more layers of insulation and/ or coverboard
- Base sheet (1 ply)
- Interply sheets (2 ply)
- Cap sheet (1 ply)
- ASTM D 312 asphalt (four moppings) (Three moppings if base sheet is self-adhered)

APPROVED BASE SHEETS:

(one of the following)

- All Weather/Empire® Base Sheet
- Black Diamond® Base Sheet (self-adhered)**
- Flintlastic Base 20
- Flintglas® Ply 4*
- Flintglas Premium Ply 6*
- Flintlastic Poly SMS
- Flintlastic Ultra Glass SA (self-adhered)**
- Flintlastic Ultra Poly SMS
- Glasbase™ Base Sheet
- Yosemite® Venting Base Sheet

APPROVED INTERPLY SHEETS (2 PLIES):

(two of the following)

- Flintglas Ply 4
- Flintglas Premium Ply 6

APPROVED CAP SHEETS:

- Flintglas MS Cap***

FLASHING ASSEMBLY:

- **Standard.** Over a base sheet or bonded to a primed substrate. One ply Flintlastic® modified cap sheet, per CT detail.
- **Premium.** Over a base sheet or bonded to a primed substrate. One smooth and one granulated modified membrane flashing, per CT detail.
- **Premium Alternate.** Over a base sheet or bonded to a primed substrate. One smooth modified membrane and CT SmartFlash®, per CT detail.

Asphalt: Type III or Type IV (Sec. 7.0).

Cants: In angles of roof deck and vertical surfaces, the roofing contractor shall furnish and install an approved cant strip with a minimum 3" face.

* For systems substituting ply sheet for the base ply, install all ply sheets in a shingled pattern. Exposure and starter dimensions should be adjusted accordingly to obtain required coverage and headlap, per NRCA recommendations.

**Coverboard not required

***Available with CoolStar® reflective granules

WARRANTY DURATIONS FOR THIS SPECIFICATION VARY BASED ON ROLL MATERIAL SELECTION; SEE WARRANTY MATRIX.

Applicable local building code may require more stringent installation requirements such as, but not limited to, increased fastener or adhesive densities to meet required wind uplift pressures. Consult local building code and uplift requirements prior to any application of CertainTeed roofing materials. CertainTeed is not responsible for failure to install roofing products per applicable local building codes.

Consult CertainTeed General Recommendations for noted section references.